



STATE OF NORTH CAROLINA
DEPARTMENT OF TRANSPORTATION

ROY COOPER
GOVERNOR

J. ERIC BOYETTE
SECRETARY

September 7, 2023

MEMORANDUM TO: Division Environmental and Construction Units

FROM: Gregory W. Price, SPWS
Division 6 Environmental Program Supervisor

SUBJECT: Environmental Permits for the Replacement of Bridges 299 &
300 on SR 1529 over Saddletree Swamp, Robeson County,
TIP HB-0007

Please find enclosed the following permit for this project:

Agency	Permit Type	Permit Expiration
US Army Corps of Engineers Section 404 Clean Water Act Permit	Regional General Permit 50	May 25, 2025
NC Division of Water Resources Section 401 Water Quality Certification	GC 4135	May 25, 2025

Work is authorized by the above referenced permit provided it is accomplished in strict accordance with the permitted plans.

The Division Environmental Office must be consulted if any deviation from the permit(s) is required.

The General Conditions and Certifications for Nationwide and Regional Permits can be referenced at:

<https://www.deq.nc.gov/about/divisions/water-resources/water-quality-permitting/401-buffer-permitting/general-certifications>

PROJECT COMMITMENTS

TIP Project No. HB-0007

Replacement of Bridge Nos. 299 & 300 over Saddletree Swamp
On SR 1529 (Mount Olive Church Road)

Robeson County

W.B.S. No. 50347.1.1

Federal Aid No. 1529(007)

COMMITMENTS FROM PROJECT DEVELOPMENT AND DESIGN

NCDOT Hydraulic Design Unit – FEMA Coordination

The Hydraulics Unit will coordinate with the NC Floodplain Mapping Program to determine status of the project regarding applicability of NCDOT's Memorandum of Agreement, or approval of a Conditional Letter of Map Revision (CLOMR) and subsequent final Letter of Map Revision (LOMR)

Division 6 Construction - FEMA

This project involves construction activities on or adjacent to FEMA-regulated stream(s). Therefore, the Division shall submit sealed as-built construction plans to the Hydraulics Unit upon completion of project construction, certifying that the drainage structures(s) and roadway embankment that are located within the 100-year floodplain were built as shown in the construction plans, both horizontally and vertically.

Division 6 Construction – Northern Long-eared Bat

Robeson County is one of the 30 counties within the known/potential range of NLEB. Therefore, if a total of 1.0 acre or more of tree clearing will occur, no tree clearing will occur during the portion of the day that the air temperature is <40 degrees Fahrenheit in order to protect NLEBs that may be in torpor.

COMMITMENTS FROM PERMITTING

No special commitments were developed during project permitting.

**U.S. ARMY CORPS OF ENGINEERS
WILMINGTON DISTRICT**

Action Id. **SAW-2023-01562** County: **Robeson County** U.S.G.S. Quad: **Northwest Lumberton**

GENERAL PERMIT (REGIONAL) VERIFICATION

Permittee: **Greg Price**
NC DOT Division 6
Address: **431 Transportation Drive**
Fayetteville NC, 28301
Telephone Number: **(910)364-0683**

Size (acres) **N/A** Nearest Town **Lumberton**
Nearest Waterway **Raft Swamp** River Basin **Lower Pee Dee**
USGS HUC **03040203** Coordinates Latitude: **34.700651**; Longitude: **-79.029304**
Location description: **Bridges 299 & 300 over Saddletree Swamp, on SR 1529, Mt Olive Church Road, north of Lumberton, NC**

Description of projects area and activity: **TIP HB-0007; Two bridge replacements impacting a total of 0.346 acre of wetlands (0.007 acre permanent fill loss, 0.028 acre of mechanized clearing, and 0.311 acre of non-404 hand clearing), and 160 linear feet/0.110 acre of tributaries (120 linear feet/0.025 acre permanent fill and bank stabilization, and 40 linear feet/0.085 acre temporary).**

Applicable Law: Section 404 (Clean Water Act, 33 USC 1344);
 Section 10 (Rivers and Harbors Act, 33 USC 403)

Authorization: Regional General Permit Number: **GP 50 - NCDOT - Bridge, Road Widening and Interchanges**
SEE ATTACHED RGP GENERAL, REGIONAL AND/OR SPECIAL CONDITIONS

Your work is authorized by the above referenced permit provided it is accomplished in strict accordance with the attached conditions and your submitted application and attached information dated August 1, 2023. Any violation of the attached conditions or deviation from your submitted plans may subject the permittee to a stop work order, a restoration order, a Class I administrative penalty, and/or appropriate legal action.

Special Condition:

1. The Wilmington District, Federal Highway Administration, U.S. Fish and Wildlife Service (USFWS), and the North Carolina Department of Transportation (NCDOT) have conducted programmatic Section 7(a)(2) consultation for the Northern long-eared bat (NLEB) for NCDOT projects located in Divisions 1-8. The result of this programmatic consultation is a Programmatic Biological Opinion (PBO) issued by the USFWS titled, "Programmatic Biological Opinion – Revised, NCDOT Program Effects on the Northern Long-eared Bat in Divisions 1-8", dated December 15, 2022. This PBO contains agreed upon conservation measures which would minimize take of NLEB. As noted in the PBO, applicability of these conservation measures varies depending on the location of the project. The USFWS has documented that no reasonable and prudent measures, nor terms and conditions, are necessary or appropriate to minimize the amount or extent of incidental take of NLEB caused by the Action; therefore, the incidental take statement does not provide reasonable and prudent measures for this species. Department of the Army (DA) authorization under general permit or standard permit (Individual Permit) is conditional upon the permittee's compliance with applicable, agreed upon conservations measures of the PBO, which is

Action ID Number: SAW-2023-01562

incorporated by reference in this verification letter. Failure to comply with the applicable conservation measures, where a take of the NLEB occurs, would constitute an unauthorized take by the permittee, and would also constitute permittee non-compliance with this verification letter. The USFWS is the appropriate authority to determine compliance with the terms and conditions of its PBO and the ESA. All PBOs can be found on our website at: <https://www.saw.usace.army.mil/Missions/Regulatory-Permit-Program/Agency-Coordination/ESA/>

This verification will remain valid until the expiration date identified below unless the nationwide and/or regional general permit authorization is modified, suspended or revoked. If, prior to the expiration date identified below, the nationwide and/or regional general permit authorization is reissued and/or modified, this verification will remain valid until the expiration date identified below, provided it complies with all requirements of the modified nationwide permit. If the nationwide and/or regional general permit authorization expires or is suspended, revoked, or is modified, such that the activity would no longer comply with the terms and conditions of the nationwide permit, activities which have commenced (i.e., are under construction) or are under contract to commence in reliance upon the nationwide and/or regional general permit, will remain authorized provided the activity is completed within twelve months of the date of the nationwide and/or regional general permit's expiration, modification or revocation, unless discretionary authority has been exercised on a case-by-case basis to modify, suspend or revoke the authorization.

This Department of the Army verification does not relieve the permittee of the responsibility to obtain any other required Federal, State or local approvals/permits.

If there are any questions regarding this verification, any of the conditions of the Permit, or the Corps of Engineers regulatory program, please contact **Eric Alsmeyer at (919) 817-1570 or Eric.C.Alsmeyer@usace.army.mil.**

Corps Regulatory Official: _____ Date: **August 7, 2023**
Expiration Date of Verification: **May 25, 2025**

The Wilmington District is committed to providing the highest level of support to the public. To help us ensure we continue to do so, please complete our Customer Satisfaction Survey, located online at <https://regulatory.ops.usace.army.mil/customer-service-survey/>

Action ID Number: SAW-2023-01562

County: Robeson County

Permittee: Greg Price
NC DOT Division 6

Project Name: NCDOT / HB-0007 / Bridge 299 & 300 / Saddletree Swamp on SR 1529 / Robeson County / Div 6

Date Verification Issued: August 7, 2023

Project Manager: Eric Alsmeyer

Upon completion of the activity authorized by this permit and any mitigation required by the permit, sign this certification and return it to the following address:

US ARMY CORPS OF ENGINEERS
WILMINGTON DISTRICT
Attn: Eric Alsmeyer
Raleigh Regulatory Field Office
3331 Heritage Trade Drive, Suite 105
Wake Forest, NC 27587
919.554.4884, Ext. 23

Please note that your permitted activity is subject to a compliance inspection by a U. S. Army Corps of Engineers representative. Failure to comply with any terms or conditions of this authorization may result in the Corps suspending, modifying or revoking the authorization and/or issuing a Class I administrative penalty, or initiating other appropriate legal action.

I hereby certify that the work authorized by the above referenced permit has been completed in accordance with the terms and condition of the said permit, and required mitigation was completed in accordance with the permit conditions.

Signature of Permittee

Date



NORTH CAROLINA
Environmental Quality

August 25, 2023

DWR # 20231089
Robeson County

ROY COOPER
Governor

ELIZABETH S. BISER
Secretary

RICHARD E. ROGERS, JR.
Director

Gregory W. Price
Division 6 Environmental Program Supervisor
North Carolina Department of Transportation
431 Transportation Drive
Fayetteville, NC 28302

Subject: APPROVAL OF 401 WATER QUALITY CERTIFICATION WITH ADDITIONAL CONDITIONS

Replace Bridge 299 & 300 over Saddletree Swamp on SR 1529,
NCDOT HB-007, Robeson County.
[Saddletree Swamp, Lumber River Basin, C;SW]

Dear Mr. Price:

You have our approval for the impacts listed below for the purpose of replacing Bridge 299 & 300 over Saddletree Swamp on SR 1529 in Robeson County. The project shall be constructed in accordance with your application dated received by the Division of Water Resources (Division) on August 1, 2023. These impacts are covered by the attached Water Quality General Certification Number 4135 and the conditions listed below. This certification is associated with the use of the Regional General Permit Number 50 once it is issued to you by the U.S. Army Corps of Engineers. Please note that you should get any other federal, state or local permits before proceeding with your project, including those required by (but not limited to) Sediment and Erosion Control, Non-Discharge, and Water Supply Watershed regulations.

The Division has determined that the proposed project will comply with water quality requirements provided that you adhere to the conditions listed in the enclosed certification and to the additional conditions itemized below.

The following proposed impacts are hereby approved. No other impacts are approved, including incidental impacts. [15A NCAC 02H .0506(b)]

Wetland Impacts in the Lumber River Basin

Site	Fill (ac)	Fill (temporary) (ac)	Excavation (ac)	Mechanized Clearing (ac)	Hand Clearing (ac)	Total Impacts (ac)	Impacts Requiring Mitigation (ac)
1	---	---	---	0.002	0.071	0.073	N/A
3	0.006	---	---	0.018	0.122	0.146	N/A
4	---	---	---	0.001	---	0.001	N/A
5	0.001	---	---	0.007	0.118	0.126	N/A
Totals	0.007	---	---	0.028	0.311	0.346	N/A

Total Wetland Impacts for Project: 0.346 acres (permanent impacts: 0.035 ac)



Stream Impacts in the Lumber River Basin

Site	Structure Size/Type	Permanent Fill in Intermittent Stream (lf)	Temporary Fill in Intermittent Stream (lf)	Permanent Fill in Perennial Stream (lf)	Temporary Fill in Perennial Stream (lf)	Total Impacts (lf)	Impacts Requiring Mitigation (lf ft)
2	Bank Stabilization	---	---	61	20	81	N/A
4	Bank Stabilization	---	---	59	20	79	N/A
Totals		---	---	120	40	160	N/A

Total Stream Impacts for Project: 160 linear feet
(permanent impacts: 120 lf)

Open Water Impacts in the Lumber River Basin

Site	Permanent Fill in Open Waters (ac)	Temporary Fill in Open Waters (ac)	Total (ac)
4	0.002	0.007	0.009
Total	0.002	0.007	0.009

Total Open Water Impacts for Project: 0.009 acres
(permanent impacts: 0.002 ac)

This approval is for the purpose and design described in your application. The plans and specifications for this project are incorporated by reference as part of this Certification. If you change your project, you must notify the Division and you may be required to submit a new application package with the appropriate fee. If the property is sold, the new owner must be given a copy of this Certification and is responsible for complying with all conditions. [15A NCAC 02H .0507(d)(2)]. If total wetland fills for this project (now or in the future) exceed 1/10 acre, or total impacts to streams (now or in the future) exceed 300 linear feet, compensatory mitigation may be required as described in 15A NCAC 2H .0506 (h) (6) and (7).

If you are unable to comply with any of the conditions of the attached Water Quality General Certification or with the additional conditions itemized below, you must notify the DWR Transportation Permitting Branch within 24 hours (or the next business day if a weekend or holiday) from the time the permittee becomes aware of the circumstances.

The permittee shall report to the Wilmington Regional Office any noncompliance with, and/or any violation of, stream or wetland standards [15A NCAC 02B .0200] including but not limited to sediment impacts to streams or wetlands. Information shall be provided orally within 24 hours (or the next business day if a weekend or holiday) from the time the permittee became aware of the non-compliance circumstances.

Additional Conditions:

1. The issuance of this certification does not exempt the Permittee from complying with any and all statutes, rules, regulations, or ordinances that may be imposed by other government agencies (i.e. local, state, and federal) having jurisdiction, including but not limited to applicable buffer rules, stormwater management rules, soil erosion and sedimentation control requirements, etc.



2. The Permittee shall ensure that the final design drawings adhere to the permit and to the permit drawings submitted for approval. [15A NCAC 02H .0507(c) and 15A NCAC 02H .0506 (b)(2) and (c)(2)]
3. The outside buffer, wetland or water boundary located within the construction corridor approved by this authorization, including all non-commercial borrow and waste sites associated with the project, shall be clearly marked by highly visible fencing prior to any land disturbing activities. Impacts to areas within the fencing are prohibited unless otherwise authorized by this certification. [15A NCAC 02H.0501 and .0502]
4. During the construction of the project, no staging of equipment of any kind is permitted in waters of the U.S., or protected riparian buffers. [15A NCAC 02H.0506(b)(2)]
5. All mechanized equipment operated near surface waters must be regularly inspected and maintained to prevent contamination of stream waters from fuels, lubricants, hydraulic fluids, or other toxic materials. [15A NCAC 02H.0506(b)(3)]
6. If concrete is used during construction, a dry work area shall be maintained to prevent direct contact between curing concrete and stream water. Water that inadvertently contacts uncured concrete shall not be discharged to surface waters due to the potential for elevated pH and possible aquatic life and fish kills. [15A NCAC 02B.0200]
7. No rock, sand or other materials shall be dredged from the stream channel except where authorized by this certification. [15A NCAC 02H.0506(b)(3)]
8. All fill slopes located in jurisdictional wetlands shall be placed at slopes no flatter than 3:1, unless otherwise authorized by this certification. [15A NCAC 02H.0506(b)(2)]
9. When applicable, all construction activities shall be performed and maintained in full compliance with G.S. Chapter 113A Article 4 (Sediment and Pollution Control Act of 1973). Regardless of applicability of the Sediment and Pollution Control Act, all projects shall incorporate appropriate Best Management Practices for the control of sediment and erosion so that no violations of state water quality standards, statutes, or rules occur. [15A NCAC 02H .0506(b)(3) and (c)(3) and 15A NCAC 02B .0200]
 - a. Design, installation, operation, and maintenance of all sediment and erosion control measures shall be equal to or exceed the requirements specified in the most recent version of the *North Carolina Sediment and Erosion Control Manual*, or for linear transportation projects, the *NCDOT Sediment and Erosion Control Manual*.
 - b. All devices shall be maintained on all construction sites, borrow sites, and waste pile (spoil) sites, including contractor-owned or leased borrow pits associated with the project. Sufficient materials required for stabilization and/or repair of erosion control measures and stormwater routing and treatment shall be on site at all times.
 - c. For borrow pit sites, the erosion and sediment control measures shall be designed, installed, operated, and maintained in accordance with the most recent version of the *North Carolina Surface Mining Manual*. Reclamation measures and implementation shall comply with the reclamation in accordance with the requirements of the Sedimentation Pollution Control Act and the Mining Act of 1971.



- d. If the project occurs in waters or watersheds classified as Primary Nursery Areas (PNAs), SA, WS-1, WS-11, High Quality Waters (HQW), or Outstanding Resource Waters (ORW), then the sedimentation and erosion control designs shall comply with the requirements set forth in 15A NCAC 04B .0124, *Design Standards in Sensitive Watershed*. [15A NCAC 02H.0506(b)(3) and (c)(3); GC 4135]
10. Sediment and erosion control measures shall not be placed in wetlands or surface waters or within 5 feet of the top of bank without prior approval from DWR. [15A NCAC 02H.0506(b)(3) and (c)(3)]
11. If placement of sediment and erosion control devices in wetlands and waters is unavoidable, then design and placement of temporary erosion control measures shall not be conducted in a manner that may result in dis-equilibrium of wetlands, stream beds, or banks, adjacent to or upstream and downstream of the above structures. All sediment and erosion control devices shall be removed from wetlands and waters and the natural grade restored within two (2) months of the date that the Division of Energy, Mining and Land Resources (DEMLR) or locally delegated program has released the specific area within the project. [15A NCAC 02H.0506(b)(3) and (c)(3)]
12. Erosion control matting that incorporates plastic mesh and/or plastic twine shall not be used along streambanks or within wetlands. Exceptions to this condition require application to and written approval from DWR. [15A NCAC 02B .0201]
13. As a condition of this 401 Water Quality Certification, the bridge demolition and construction must be accomplished in strict compliance with the most recent version of NCDOT's Best Management Practices for Construction and Maintenance Activities. [15A NCAC 02H .0507(d)(2) and 15A NCAC 02H .0506(b)(5)]
14. Bridge deck drains shall not discharge directly into the stream. Stormwater shall be directed across the bridge and pre-treated through site-appropriate means (grassed swales, pre-formed scour holes, vegetated buffers, etc.) where possible before entering the stream. To meet the requirements of NCDOT's NPDES permit NCS0000250, please refer to the most recent version of the North Carolina Department of Transportation Stormwater Best Management Practices Toolbox manual for approved measures. [15A NCAC 02H .0507(d)(2) and 15A NCAC 02H .0506(b)(5)]
15. All bridge construction shall be performed from the existing bridge, temporary work bridges, temporary causeways, or floating or sunken barges. If work conditions require barges, they shall be floated into position and then sunk. The barges shall not be sunk and then dragged into position. Under no circumstances should barges be dragged along the bottom of the surface water. [15A NCAC 02H .0506(b)(3)]
16. Bridge piles and bents shall be constructed using driven piles (hammer or vibratory) or drilled shaft construction methods. More specifically, jetting or other methods of pile driving are prohibited without prior written approval from the NCDWR first. [15A NCAC 02H.0506(b)(2)]
17. The use of rip-rap above the Normal High Water Mark shall be minimized. Any rip-rap placed for stream stabilization shall be placed in stream channels in such a manner that it does not impede aquatic life passage. [15A NCAC 02H.0506(b)(2)]



18. Any rip-rap required for proper culvert placement, stream stabilization, or restoration of temporarily disturbed areas shall be restricted to the area directly impacted by the approved construction activity. All rip-rap shall be placed such that the original streambed elevation and streambank contours are restored and maintained and shall consist of clean rock or masonry material free of debris or toxic pollutants. Placement of rip-rap or other approved materials shall not result in de-stabilization of the stream bed or banks upstream or downstream of the area or be installed in a manner that precludes aquatic life passage. [15A NCAC 02H .0506(b); 15A NCAC 02H .0507(c)]
19. Any rip-rap used for stream or shoreline stabilization shall be of a size and density to prevent movement by wave, current action, or stream flows, and shall consist of clean rock or masonry material free of debris or toxic pollutants. Rip-rap shall not be installed in the streambed except in specific areas required for velocity control and to ensure structural integrity of bank stabilization measures. [15A NCAC 02H .0506(b); 15A NCAC 02H .0507(c); 15A NCAC 02B .0201]
20. The dimension, pattern and profile of the stream above and below the crossing shall not be modified. Disturbed floodplains and streams shall be restored to natural geomorphic conditions. [15A NCAC 02H.0506(b)(2)]
21. No drill slurry or water that has been in contact with uncured concrete shall be allowed to enter surface waters. This water shall be captured, treated, and disposed of properly. [15A NCAC 02H .0506(b)(3)]
22. A turbidity curtain will be installed in the stream if driving or drilling activities occur within the stream channel, on the stream bank, or within 5 feet of the top of bank, or during the removal of bents from an old bridge. This condition can be waived with prior approval from the NCDWR. [15A NCAC 02H .0506(b)(3)]
23. Native riparian vegetation must be reestablished in the riparian areas within the construction limits of the project by the end of the growing season following completion of construction. [15A NCAC 02H.0506(b)(2)]
24. Discharging hydroseed mixtures and washing out hydroseeders and other equipment in or adjacent to surface waters is prohibited. [15A NCAC 02H.0506(b)(3)]
25. NCDOT shall be in compliance with the NCS00250 issued to the NCDOT, including the applicable requirements of the NCG01000.
26. The permittee and its authorized agents shall conduct its activities in a manner consistent with State water quality standards (including any requirements resulting from compliance with §303(d) of the Clean Water Act) and any other appropriate requirements of State and Federal law. If the NCDWR determines that such standards or laws are not being met (including the failure to sustain a designated or achieved use) or that State or federal law is being violated, or that further conditions are necessary to assure compliance, the NCDWR may reevaluate and modify this certification. [15A NCAC 02B.0200]
27. The Permittee shall report any violations of this certification to the Division of Water Resources within 24 hours of discovery. [15A NCAC 02B.0506(b)(2)]



28. The NCDOT will conduct a pre-construction meeting with all appropriate staff to ensure that the project supervisor and essential staff understand the permit conditions and any potential issues at the permitted site. NCDWR staff shall be invited to the pre-construction meeting. [15A NCAC 02H.0506(b)(2) and (b)(3)]
29. Upon completion of the project (including any impacts at associated borrow or waste sites), the NCDOT Division Engineer shall complete the "Certification of Completion Form" to notify the NCDWR when all work included in the 401 Certification has been completed. [15A NCAC 02H.0502(f)]
30. A copy of this Water Quality Certification shall be maintained on the construction site at all times. In addition, the Water Quality Certification and all subsequent modifications, if any, shall be maintained with the Division Engineer and the on-site project manager. [15A NCAC 02H .0507(c) and 15A NCAC 02H .0506 (b)(2) and (c)(2)]

This approval and its conditions are final and binding unless contested [G.S. 143-215.5]. Please be aware that impacting waters without first applying for and securing the issuance of a 401 Water Quality Certification violates Title 15A of the North Carolina Administrative Code (NCAC) 2H .0500. Title 15A NCAC 2H .0500 requires certifications pursuant to Section 401 of the Clean Water Act whenever construction or operation of facilities will result in a discharge into navigable waters, including wetlands, as described in 33 Code of Federal Regulations (CFR) Part 323. It also states any person desiring issuance of the State certification or coverage under a general certification required by Section 401 of the Federal Water Pollution Control Act shall file with the Director of the North Carolina Division of Water Quality. Pursuant to G.S. 143-215.6A, these violations and any future violations are subject to a civil penalty assessment of up to a maximum of \$25,000.00 per day for each violation.

This Certification can be contested as provided in Chapter 150B of the North Carolina General Statutes by filing a Petition for a Contested Case Hearing (Petition) with the North Carolina Office of Administrative Hearings (OAH) within sixty (60) calendar days. Requirements for filing a Petition are set forth in Chapter 150B of the North Carolina General Statutes and Title 26 of the North Carolina Administrative Code. Additional information regarding requirements for filing a Petition and Petition forms may be accessed at <http://www.ncoah.com/> or by calling the OAH Clerk's Office at (919) 431-3000.

A party filing a Petition must serve a copy of the Petition on:

William F. Lane, General Counsel
Department of Environmental Quality
1601 Mail Service Center
Raleigh, NC 27699-1601

If the party filing the Petition is not the permittee, then the party must also serve the recipient of the Certification in accordance with N.C.G.S 150B-23(a).



This letter completes the review of the Division under section 401 of the Clean Water Act and 15A NCAC 02H .0500. Please contact Hannah Sprinkle at hannah.sprinkle@deq.nc.gov if you have any questions or concerns.

Sincerely,

DocuSigned by:

4F4DD2F21EA846E...

Richard E. Rogers, Jr., Director
Division of Water Resources

cc:

Eric Alsmeyer, USACE Wilmington Regulatory Field Office (via email)
Gregory Price, Division 6 Environmental Officer
Gary Jordan, US Fish and Wildlife Service
Travis Wilson, NC Wildlife Resources Commission
Hannah Sprinkle, NC Division of Water Resources Wilmington Regional Office
File Copy



NCDWR Project No.: _____ County: _____

Applicant: _____

Project Name: _____

Date of Issuance of 401 Water Quality Certification: _____

Certificate of Completion

Upon completion of all work approved within the 401 Water Quality Certification or applicable Buffer Rules, and any subsequent modifications, the applicant is required to return this certificate to the 401 Transportation Permitting Unit, North Carolina Division of Water Resources, 1617 Mail Service Center, Raleigh, NC, 27699-1617. This form may be returned to NCDWR by the applicant, the applicant's authorized agent, or the project engineer. It is not necessary to send certificates from all of these.

Applicant's Certification

I, _____, hereby state that, to the best of my abilities, due care and diligence was used in the observation of the construction such that the construction was observed to be built within substantial compliance and intent of the 401 Water Quality Certification and Buffer Rules, the approved plans and specifications, and other supporting materials.

Signature: _____ Date: _____

Agent's Certification

I, _____, hereby state that, to the best of my abilities, due care and diligence was used in the observation of the construction such that the construction was observed to be built within substantial compliance and intent of the 401 Water Quality Certification and Buffer Rules, the approved plans and specifications, and other supporting materials.

Signature: _____ Date: _____

Engineer's Certification

_____ Partial _____ Final

I, _____, as a duly registered Professional Engineer in the State of North Carolina, having been authorized to observe (periodically, weekly, full time) the construction of the project for the Permittee hereby state that, to the best of my abilities, due care and diligence was used in the observation of the construction such that the construction was observed to be built within substantial compliance and intent of the 401 Water Quality Certification and Buffer Rules, the approved plans and specifications, and other supporting materials.

Signature _____ Registration No. _____
Date _____



09/08/99

X:\NCDOT\Division 6 Robeson 299 300\Hydraulics\PERMITS_Environmental\Drawings\HB-0007_Hyd_prm.tsh.dgn User:bhenegar 2/16/2023

PROJECT: HB-0007

CONTRACT:

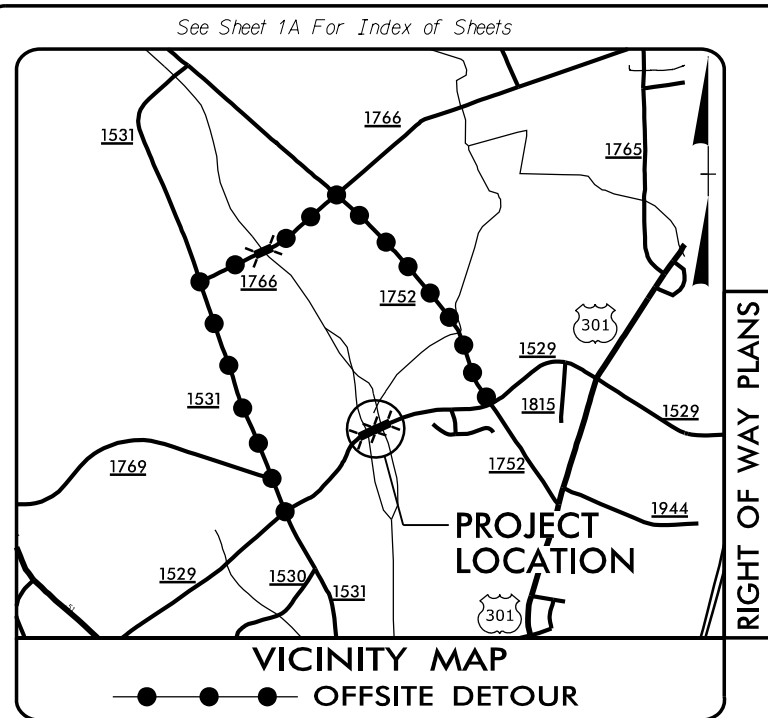

STATE OF NORTH CAROLINA
DIVISION OF HIGHWAYS
ROBESON COUNTY

LOCATION: BRIDGE #770299 & BRIDGE #770300 OVER SADDLETREE SWAMP
ON SR 1529 (MT OLIVE CHURCH RD)

TYPE OF WORK: GRADING, DRAINAGE, PAVING, AND STRUCTURE

PERMIT DRAWINGS
2-16-2023

PERMIT DRAWING
SHEET 1 OF 5

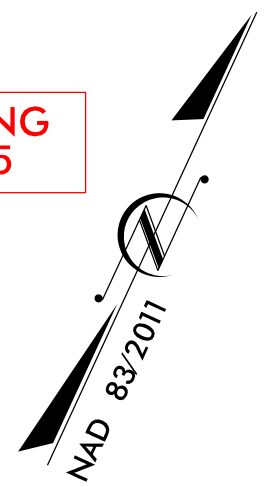

STATE	STATE PROJECT REFERENCE NO.	SHEET NO.	TOTAL SHEETS
N.C.	HB-0007	1	
STATE PROJ. NO.	F.A. PROJ. NO.	DESCRIPTION	
50347.1.1	1529(007)	PE	
50347.2.1	1529(007)	UTIL & RW	
50347.3.1	1529(007)	CONST.	

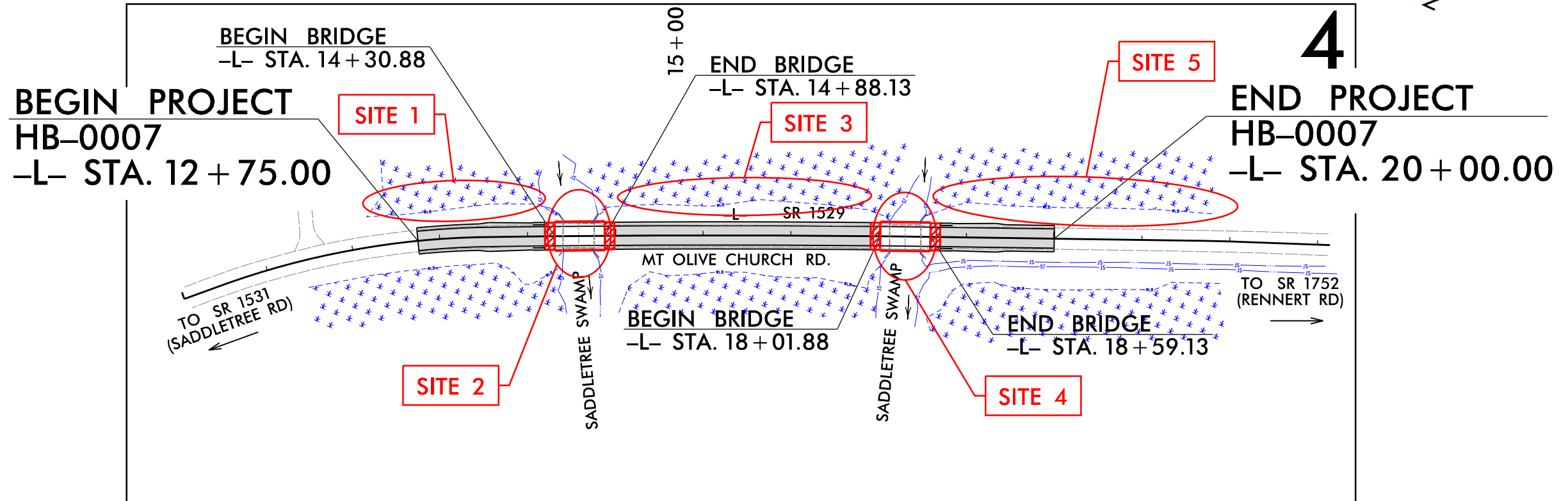

THIS PROJECT IS NOT WITHIN ANY MUNICIPAL BOUNDARIES.
CLEARING ON THIS PROJECT SHALL BE PERFORMED TO THE LIMITS ESTABLISHED BY METHOD II MODIFIED.

DOCUMENT NOT CONSIDERED FINAL
UNLESS ALL SIGNATURES COMPLETED

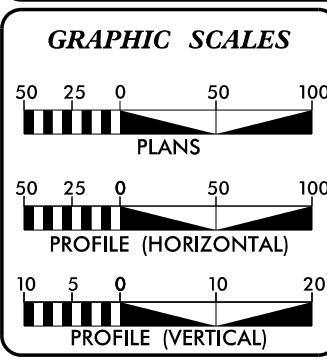

DESIGN DATA

ADT 2024 =	3242
ADT 2045 =	3600
T =	7 % *
V =	60 MPH
* TTST =	3% DUAL = 4%
FUNC CLASS =	LOCAL (RURAL)
SUB-REGIONAL TIER	

PROJECT LENGTH

LENGTH ROADWAY PROJECT HB-0007	= 0.115
LENGTH STRUCTURE PROJECT HB-0007	= 0.022
TOTAL LENGTH PROJECT HB-0007	= 0.137

NCDOT CONTACT: ADAM BRITT

PLANS PREPARED BY:	PLANS PREPARED FOR:
 TGS ENGINEERS 201 W. MARION ST SUITE 200 SHELBY, NC 28150 PH (704) 476-0003 CORP. LICENSE NO.: C-0275	NORTH CAROLINA DEPARTMENT OF TRANSPORTATION DIVISION 6 558 Gillespie St Fayetteville, NC 28301
RIGHT OF WAY DATE: JAN. 20, 2023	JIMMY TERRY, PE PROJECT ENGINEER
LETTING DATE: DEC. 6, 2023	AUSTIN TURNER, PE PROJECT DESIGN ENGINEER
2018 STANDARD SPECIFICATIONS	

HYDRAULICS ENGINEER



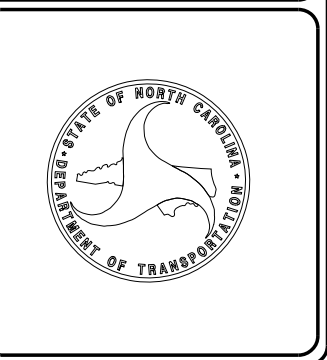

SIGNATURE: _____ P.E.

ROADWAY DESIGN ENGINEER

SIGNATURE: _____ P.E.



FOR STRUCTURE PLANS, SEE SHEET S-1 THRU S-??

-  DENOTES FILL IN WETLAND
-  DENOTES HAND CLEARING
-  DENOTES MECHANIZED CLEARING
-  DENOTES IMPACTS IN SURFACE WATER
-  DENOTES TEMPORARY IMPACTS IN SURFACE WATER

WETLAND AND SURFACE WATER IMPACTS

PERMIT DRAWING SHEET 2 OF 5

TGS ENGINEERS
201 W. MARION ST
SUITE 200
SHELBY, NC 28150
PH (704) 476-0003
CORP. LICENSE NO.: C-0275

ROBESON COUNTY
BRIDGES #770299
& #770300

PROJECT REFERENCE NO. HB-0007	SHEET NO. 4
ROADWAY DESIGN ENGINEER	HYDRAULICS ENGINEER
DOCUMENT NOT CONSIDERED FINAL UNLESS ALL SIGNATURES COMPLETED	

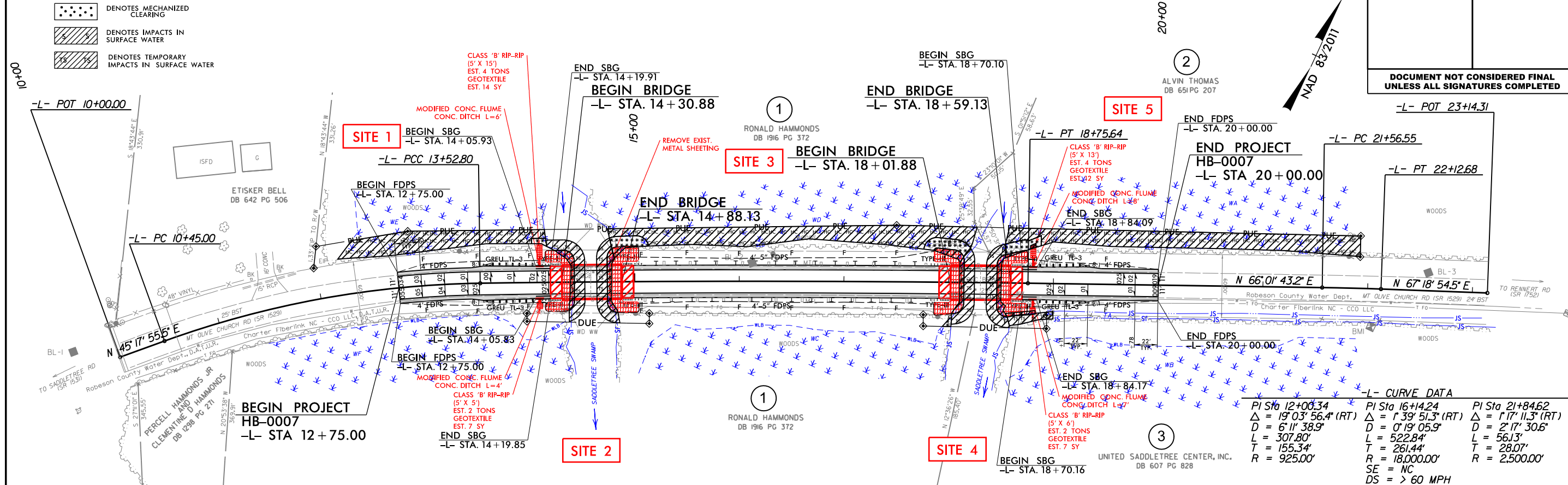



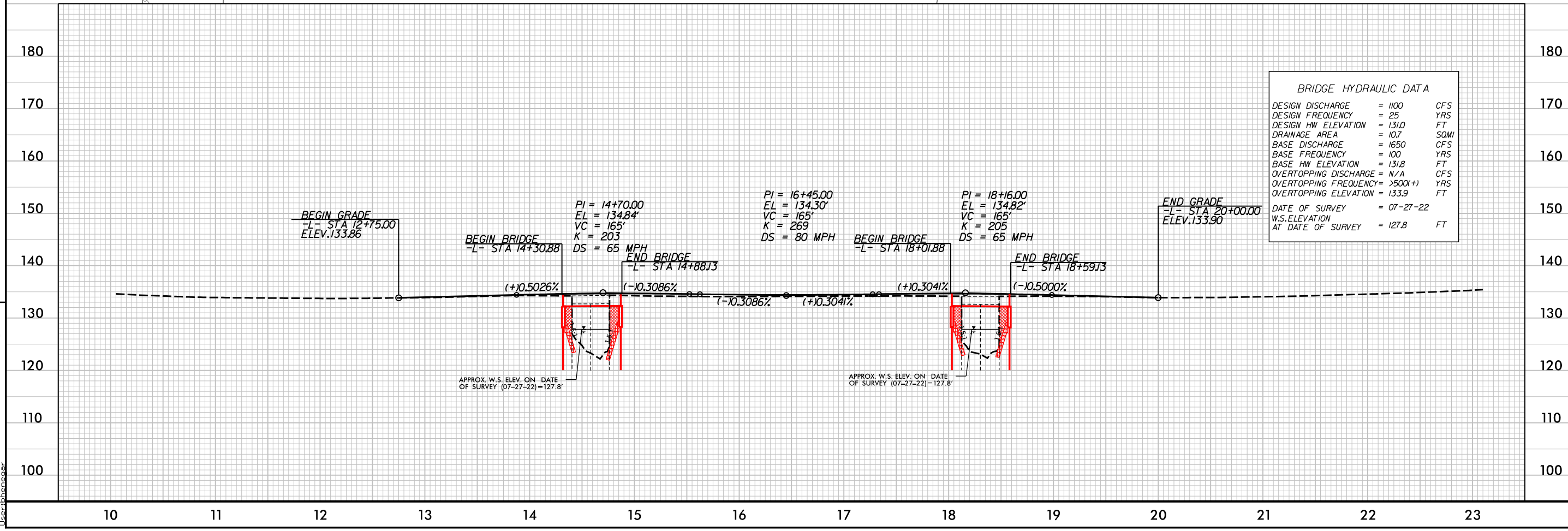

-L- CURVE DATA

PI Sta 12+00.34	PI Sta 16+14.24	PI Sta 21+84.62
$\Delta = 19^{\circ} 03' 56.4"$ (RT)	$\Delta = 1^{\circ} 39' 51.3"$ (RT)	$\Delta = 1^{\circ} 17' 11.3"$ (RT)
D = 6' 11" 38.9"	D = 0' 19" 05.9"	D = 2' 17" 30.6"
L = 307.80'	L = 522.84'	L = 56.13'
T = 155.34'	T = 261.44'	T = 28.07'
R = 925.00'	R = 18,000.00'	R = 2,500.00'
SE = NC		
DS = > 60 MPH		



8/17/99
 REVISIONS
 2/10/2023 Division 6 Robeson 299_300_Hydro\utils\Drawings\HB-0007_Hyd.prm.psh.dgn
 User: jhansgar

FOR STRUCTURE PLANS, SEE SHEET S-1 THRU S-??

-  DENOTES FILL IN WETLAND
-  DENOTES HAND CLEARING
-  DENOTES MECHANIZED CLEARING
-  DENOTES IMPACTS IN SURFACE WATER
-  DENOTES TEMPORARY IMPACTS IN SURFACE WATER

WETLAND AND SURFACE WATER IMPACTS

PERMIT DRAWING SHEET 3 OF 5

TGS ENGINEERS
201 W. MARION ST
SUITE 200
SHELBY, NC 28150
PH (704) 476-0003
CORP. LICENSE NO.: C-0275

ROBESON COUNTY
BRIDGES #770299
& #770300

PROJECT REFERENCE NO. HB-0007	SHEET NO. 4
ROADWAY DESIGN ENGINEER	HYDRAULICS ENGINEER
DOCUMENT NOT CONSIDERED FINAL UNLESS ALL SIGNATURES COMPLETED	

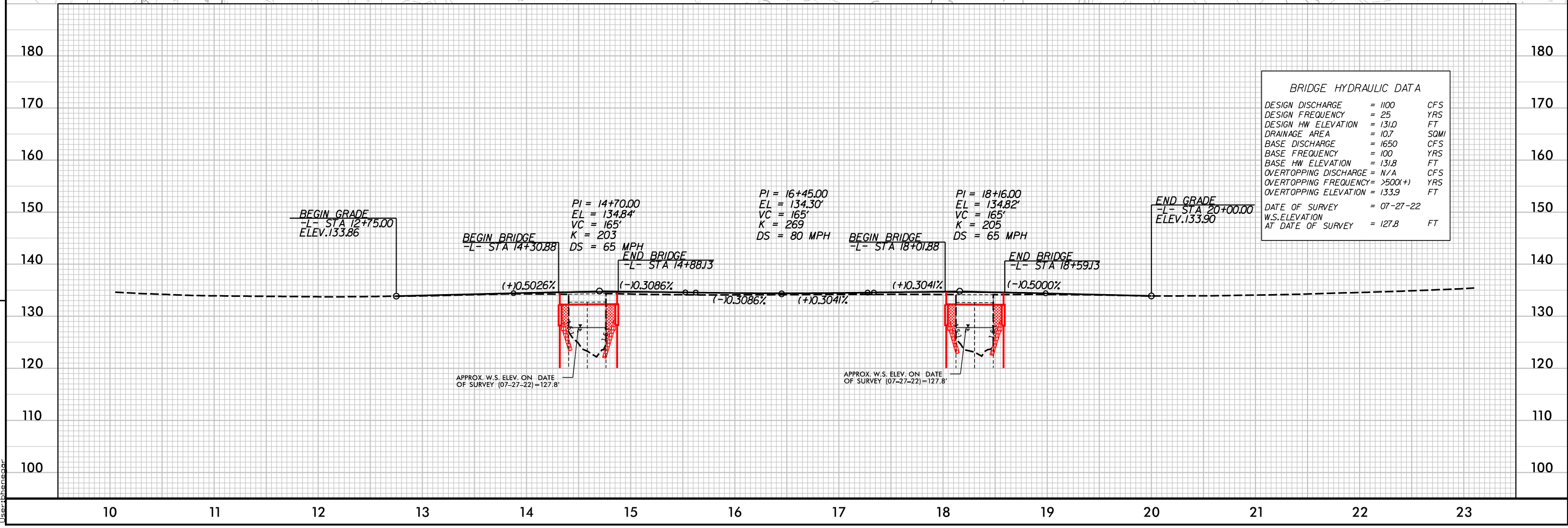
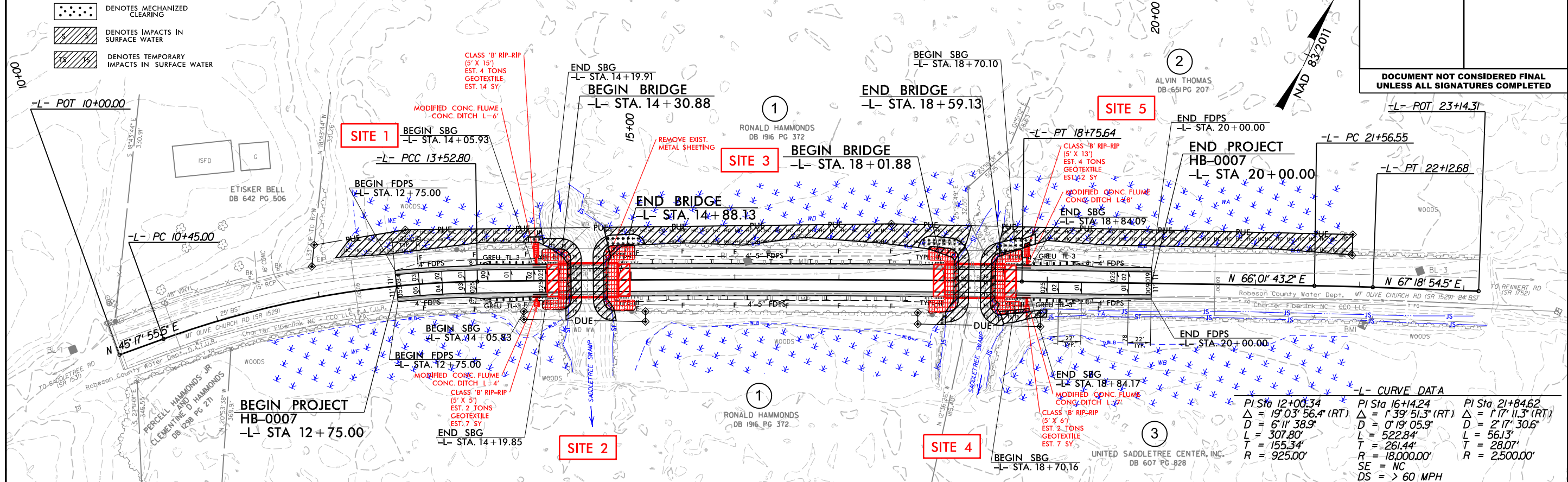

8/17/99
 2/10/2023
 Division 6 Robeson 299_300_Hydro-Permits_Environmental Drawings\Drawings\HB-0007_Hyd-prm-psh-con.dgn
 User: jhansen

5/14/99
2:\N\2023\Division 6 Robeson 299_300\Hydraulics\PERMITS-Environmental\Drawings\HB-0007_Hyd-prm_xsc.dgn
User: jhanson

PROJECT REFERENCE NO. <i>HB-0007</i>	SHEET NO.
ROADWAY DESIGN ENGINEER	HYDRAULICS ENGINEER
DOCUMENT NOT CONSIDERED FINAL UNLESS ALL SIGNATURES COMPLETED	

**PERMIT DRAWING
SHEET 4 OF 5**

 DENOTES HAND CLEARING

SCALE
1" = 20' HORIZONTAL
1" = 20' VERTICAL

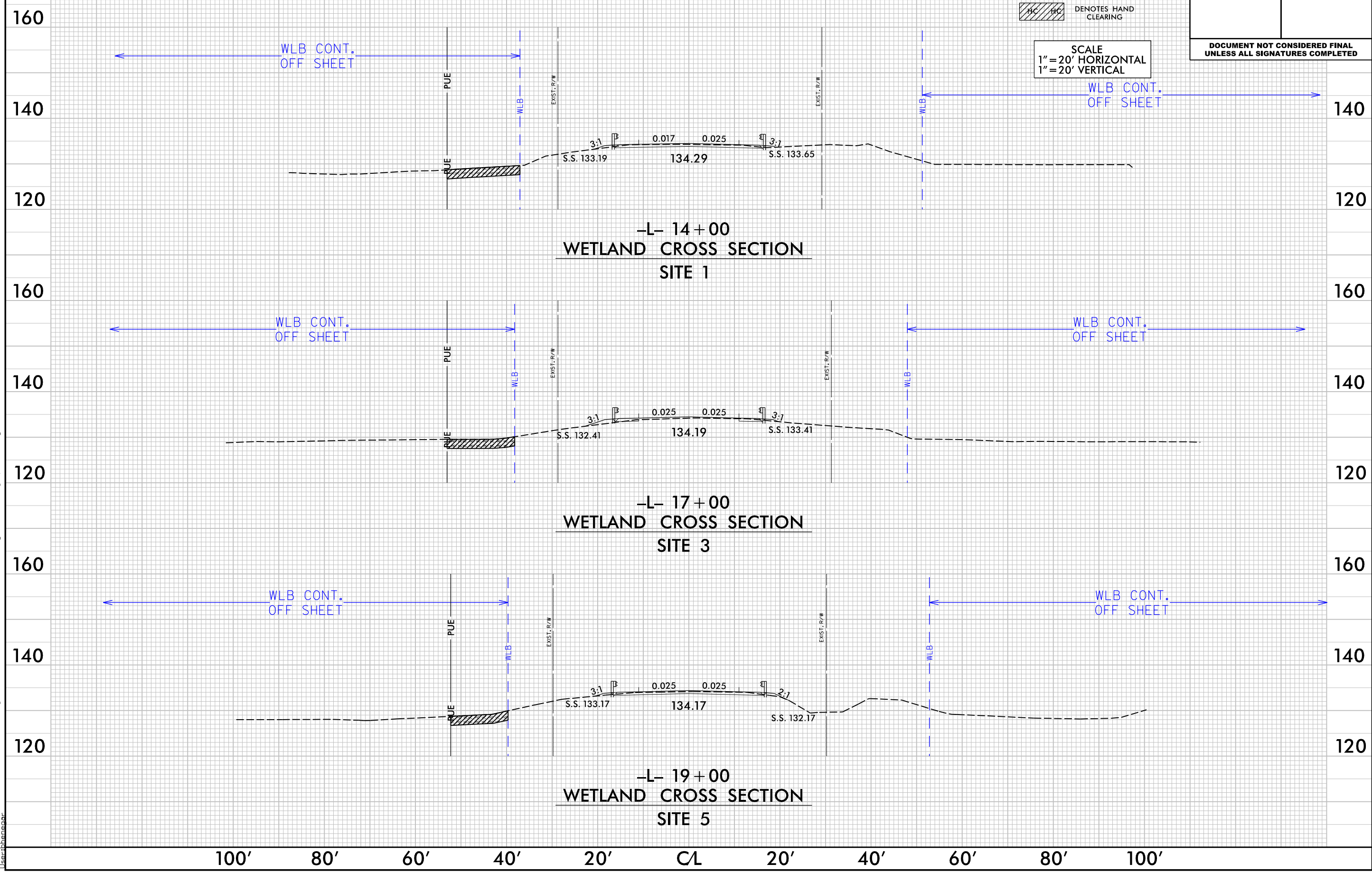

WETLAND AND SURFACE WATER IMPACTS SUMMARY

Site No.	Station (From/To)	Structure Size / Type	NRTR Map ID	WETLAND IMPACTS					SURFACE WATER IMPACTS				
				Permanent Fill In Wetlands (ac)	Temp. Fill In Wetlands (ac)	Excavation in Wetlands (ac)	Mechanized Clearing in Wetlands (ac)	Hand Clearing in Wetlands (ac)	Permanent SW impacts (ac)	Temp. SW impacts (ac)	Existing Channel Impacts Permanent (ft)	Existing Channel Impacts Temp. (ft)	Natural Stream Design (ft)
1	-L- 12+22 to 14+16 LT	Hand Clearing in Wetlands	WE					0.071					
1	-L- 14+02 to 14+17 LT	Mechanized Clearing in Wetlands	WE				0.002						
2	-L- 14+17 to 14+86 LT & RT	Bank Stabilization	Saddletree Swamp						0.012	0.041	61	20	
3	-L- 14+79 to 15+03 LT	Fill in Wetlands	WD	0.002									
3	-L- 14+76 to 15+14 LT	Mechanized Clearing in Wetlands	WD				0.008						
3	-L- 14+74 to 18+27 LT	Hand Clearing in Wetlands	WD					0.122					
3	-L- 17+76 to 18+21 LT	Mechanized Clearing in Wetlands	WD				0.010						
3	-L- 17+86 to 18+14 LT	Fill in Wetlands	WD	0.004									
4	-L- 18+03 to 18+59 LT & RT	Bank Stabilization	Saddletree Swamp						0.011	0.037	59	20	
4	-L- 18+56 to 18+88 RT	Bank Stabilization	TA						0.002	0.007			
4	-L- 17+95 to 18+03 RT	Mechanized Clearing in Wetlands	WC				0.001						
5	-L- 18+54 to 18+83 LT	Fill in Wetlands	WA	0.001									
5	-L- 18+54 to 18+88 LT	Mechanized Clearing in Wetlands	WA				0.007						
5	-L- 18+54 to 21+92 LT	Hand Clearing in Wetlands	WA					0.118					
TOTALS:				0.007			0.028	0.311	0.025	0.085	120	40	

NOTES:

NC DEPARTMENT OF TRANSPORTATION
 DIVISION OF HIGHWAYS
 2/16/23
 Robeson County
 HB-0007
 50347.1.1